

PUBLIC PATH DIVERSION ORDER

HIGHWAYS ACT 1980

MID SUFFOLK DISTRICT COUNCIL (STOWMARKET FOOTPATHS 18(PART) AND 62) PUBLIC PATH DIVERSION ORDER 2025

This order is made by Mid Suffolk District Council ("the authority") under section 119 of the Highways Act 1980 ("the 1980 Act") because it appears to the authority that in the interests of the owners of the land crossed by the footpaths described in paragraph 1 of this order and of the public it is expedient that the lines of the paths should be diverted.

Mid Suffolk District Council has agreed to defray any compensation which becomes payable in consequence of the coming into force of the order, and any expenses which are incurred in bringing the new sites of the paths into a fit condition for use by the public.

Suffolk County Council has been consulted as required by section 120(2) of the 1980 Act and Suffolk County Council has consented to the making of the order.

BY THIS ORDER:

1. The public rights of way over the land situate at Stowmarket and shown by bold continuous lines on the map contained in this order and described in Part 1 of the Schedule to this order shall be stopped up on the date of confirmation of this order.
2. There shall on the date of confirmation of this order be public footpaths over the land situate at Stowmarket described in Part 2 of the Schedule and shown by bold broken lines on the map contained in this order.

GIVEN under the Common Seal of Mid Suffolk District Council this 27th day of November 2025

THE COMMON SEAL of)
MID SUFFOLK DISTRICT)
COUNCIL was hereunto)
affixed in the presence of:)



13115

Caw

Authorised Officer

Mid Suffolk District Council hereby confirms the foregoing Order given under the Common Seal of Mid Suffolk District Council this 22nd day of January 2026

THE COMMON SEAL of
MID SUFFOLK DISTRICT
COUNCIL was hereunto
affixed in the presence of:

[Signature]
Authorised Officer



13135

SCHEDULE

PART 1

DESCRIPTION OF SITES OF EXISTING PATHS

Stowmarket Footpath 18(part) - The entire width of that part of Stowmarket Footpath 18 commencing at Ordnance Survey grid reference TM04435889 at point A and proceeding in a north westerly direction for approximately 29 metres to Ordnance Survey grid reference TM0441358913 at point B; this being the route shown between points A – B on the order map.

Stowmarket Footpath 62 – The whole of Stowmarket Footpath 62 commencing at Ordnance Survey grid reference TM04435889 at point A at a junction with Stowmarket Footpath 18 and proceeding in a north easterly direction for 11 metres to join Stowmarket Restricted Byway 55 at Ordnance Survey grid reference TM 04445891 at point C; this being the route shown between points A – C on the order map.

PART 2

DESCRIPTION OF SITES OF NEW PATHS

Stowmarket Footpath 18(part) - Commencing at Ordnance Survey grid reference TM04435889 at point A at a junction with Stowmarket Footpath 62 and proceeding in a north westerly direction adjacent to a row of parking bays for approximately 27.5 metres to Ordnance Survey grid reference TM0441458911 at point D then in a north north westerly direction for approximately 2.5 metres to join the existing route at Ordnance Survey grid reference TM0441358913 at point B; this being the route shown between points A – D – B on the order map.

Width: Varying between 1.8 metres and 2.5 metres

Stowmarket Footpath 62 - Commencing at Ordnance Survey grid reference TM04435889 at point A at a junction with Stowmarket Footpath 18 and proceeding in an east south easterly direction for approximately 4.5 metres to Ordnance Survey grid reference TM04445889 at point E then in a north north easterly direction for approximately 11 metres to join Stowmarket Restricted Byway 55 at the U4541 road (Walnut Tree Walk) at Ordnance Survey grid reference TM04445890 at point F; this being the route shown between points A – E – F on the order map.

Width: Varying between 1.64 metres and 2.5 metres

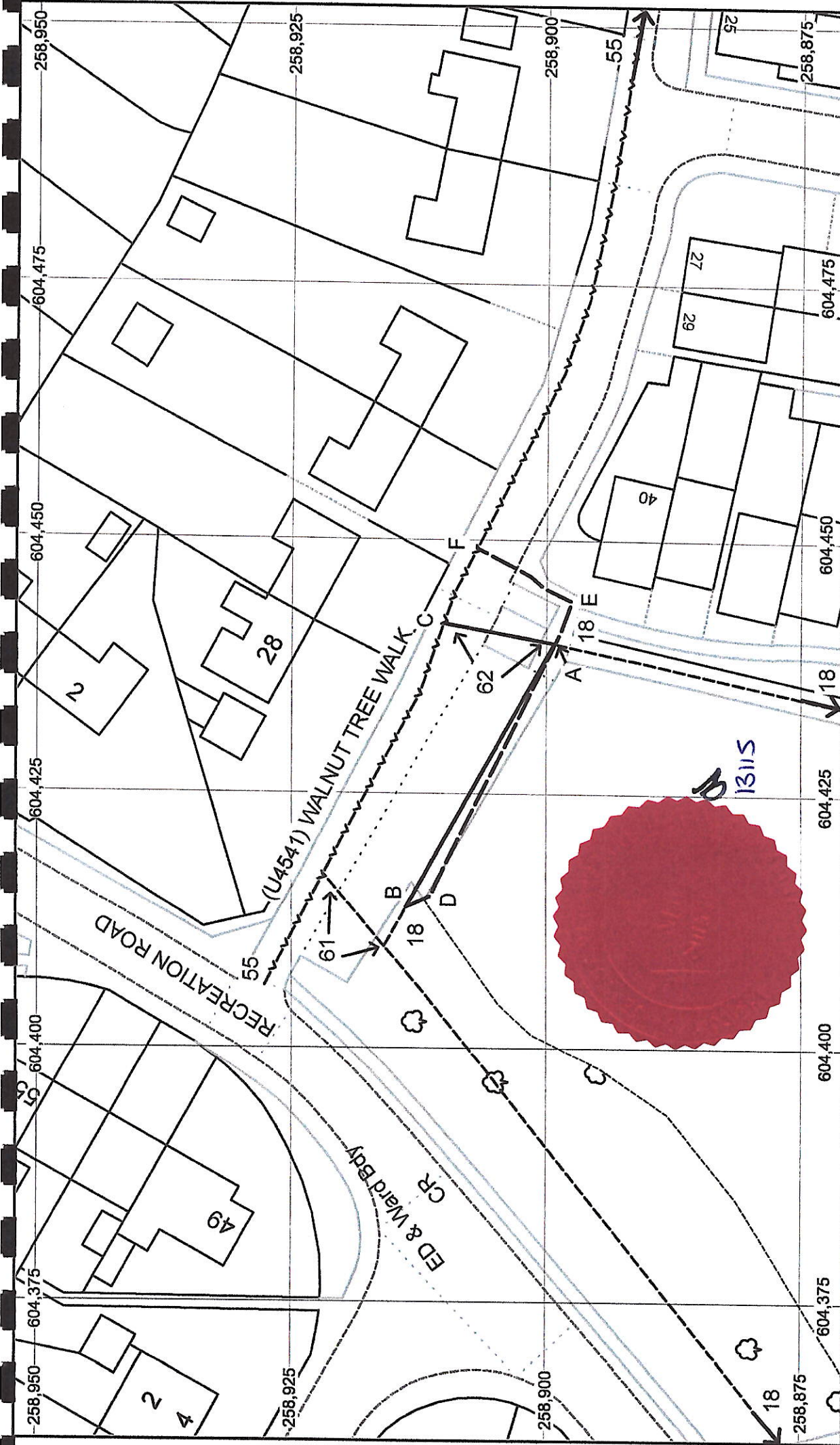

MAP REFERRED TO IN THE MID SUFFOLK DISTRICT COUNCIL (STOWMARKET FOOTPATHS 18(PART) AND 62) PUBLIC PATH DIVERSION ORDER 2025 - HIGHWAYS ACT 1980 SECTION 119

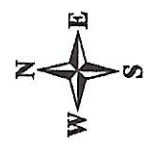

Scale: 1:500 at A4

- Footpath to be diverted (A-B) (A-C)
- - - Proposed footpath (A-D-B) (A-E-F)
- ... Unaffected Footpath
- - - - - Unaffected Restricted Byway

