

PUBLIC PATH DIVERSION ORDER

TOWN AND COUNTRY PLANNING ACT 1990, SECTION 257

MID SUFFOLK DISTRICT COUNCIL (STONHAM ASPAL FOOTPATHS 25, 28(PART) AND 36) PUBLIC PATH STOPPING UP ORDER 2024

This order is made by Mid Suffolk District Council under section 257 of the Town and Country Planning Act 1990 ("the 1990 Act") because it is satisfied that it is necessary to stop up the footpaths to which this order relates in order to enable development to be carried out in accordance with planning permission granted under Part III of the Town and Country Planning Act 1990 namely: DC/19/02299 - Erection of 46 dwellings, sport pitches and a sports community building with associated access improvements, parking, play space, infiltration basin and landscaping, land south of The Street, Stonham Aspal, Suffolk, IP14 6AN.

BY THIS ORDER:

1. The footpaths over the land shown by a bold black line on the attached map between points A – B, C – A and D – E – A and described in Part 1 of the Schedule to this order ("the Schedule") shall be stopped up as provided below.
2. There shall be created to the reasonable satisfaction of Mid Suffolk District Council alternative highways for use as replacements for the said footpaths as provided in Part 2 of the Schedule and shown by bold black dashes on the attached map between points F – G, C – H – F, and J – K – L – M – C.
3. The stopping up of the footpaths shall have effect on the date on which Mid Suffolk District Council certifies that the terms of Article 2 have been complied with.
4. The following works shall be carried out in relation to the highways described in Part 2 of the Schedule hereto, that is to say: The developer shall provide the footpaths in accordance with the Certificate of Works issued by Suffolk County Council on 29 May 2024.

5. Orbit Homes 2020 Limited is hereby required to pay the cost of carrying out the necessary works.

6. Where immediately before the date on which the footpaths are stopped up there is apparatus under, in, over or across it belonging to statutory undertakers for the purposes of carrying out their undertaking, the undertakers shall continue to have the same rights in respect of the apparatus as they then had.

GIVEN under the Common Seal of Mid Suffolk District Council this 17th day of *October* 2024

THE COMMON SEAL of)
MID SUFFOLK DISTRICT)
COUNCIL was hereunto)
affixed in the presence of:)



Authorised Officer

SCHEDULE

PART 1

DESCRIPTION OF SITE OF EXISTING FOOTPATHS

Stonham Aspal Footpath 25 – The whole of Stonham Aspal Footpath 25 commencing at Ordnance Survey grid reference TM13905898 at point A at a junction with Stonham Aspal Footpaths 28 and 36 and proceeding in a south south easterly direction for approximately 55 metres to a junction with Stonham Aspal Footpaths 24 and 26 at Ordnance Survey grid reference TM13935893 at point B; this being the route shown between points A – B on the order map.

Stonham Aspal Footpath 28(part) – The entire width of that part of Stonham Aspal Footpath 28 commencing at Ordnance Survey grid reference TM13855908 at point C and proceeding in a south south easterly direction for approximately 116 metres to a junction with Stonham Aspal Footpaths 25 and 36 at Ordnance Survey grid reference TM13905898 at point A; this being the route shown between points C – A on the order map.

Stonham Aspal Footpath 36 – The whole of Stonham Aspal Footpath 36 commencing at Ordnance Survey grid reference TM14065919 at point D from the A1120 road (The Street) and proceeding in a west south westerly direction for approximately 146 metres to Ordnance Survey grid reference TM13935912 at point E then in a south south westerly direction for approximately 143 metres to a junction with Stonham Aspal Footpaths 25 and 28 at Ordnance Survey grid reference TM13905898 at point A; this being the route shown between points D – E – A on the order map.

PART 2

DESCRIPTION OF SITE OF ALTERNATIVE HIGHWAYS

Stonham Aspal Footpath 25 – Commencing at Ordnance Survey grid reference TM13895894 at point F at a junction with the new route of Stonham Aspal Footpath 28 and proceeding in a south easterly direction for approximately 32 metres to a junction with Stonham Aspal Footpath 26 at Ordnance Survey grid reference TM13925892 at point G; this being the route shown between points F – G on the order map.

Width: 1.5 metres

Stonham Aspal Footpath 28 (part) – Commencing at Ordnance Survey grid reference TM13855908 at point C at a junction with the new route of Stonham Aspal Footpath 36 and proceeding in a west south westerly direction for approximately 24 metres passing to the north of a sports pitch to Ordnance Survey grid reference TM13835907 at point H then in a south south easterly direction for approximately 147 metres passing to the west of a sports pitch to a junction with the new route of Stonham Aspal Footpath 25 at Ordnance Survey grid reference TM13895894 at point F; this being the route shown between points C – H – F on the order map.

Width: 1.5 metres

Stonham Aspal Footpath 36 – Commencing at Ordnance Survey grid reference TM14055919 at point J from the A1120 road (The Street) and proceeding for approximately 99 metres along an estate path first in a southerly direction then in a generally west south westerly direction to an estate road at Ordnance Survey grid reference TM13975914 at point K then crossing the estate road in a south westerly direction for approximately 11 metres to Ordnance Survey grid reference TM13965913 at point L then following the estate path in a south westerly direction for approximately 29 metres to Ordnance Survey grid reference TM13945912 at point M then for approximately 101 metres in a westerly and then west south westerly direction passing to the north of a sports pitch to a junction with Stonham Aspal Footpath 28 at Ordnance Survey grid reference TM13855908 at point C ; this being the route shown between points D – K – L – M – C on the order map.

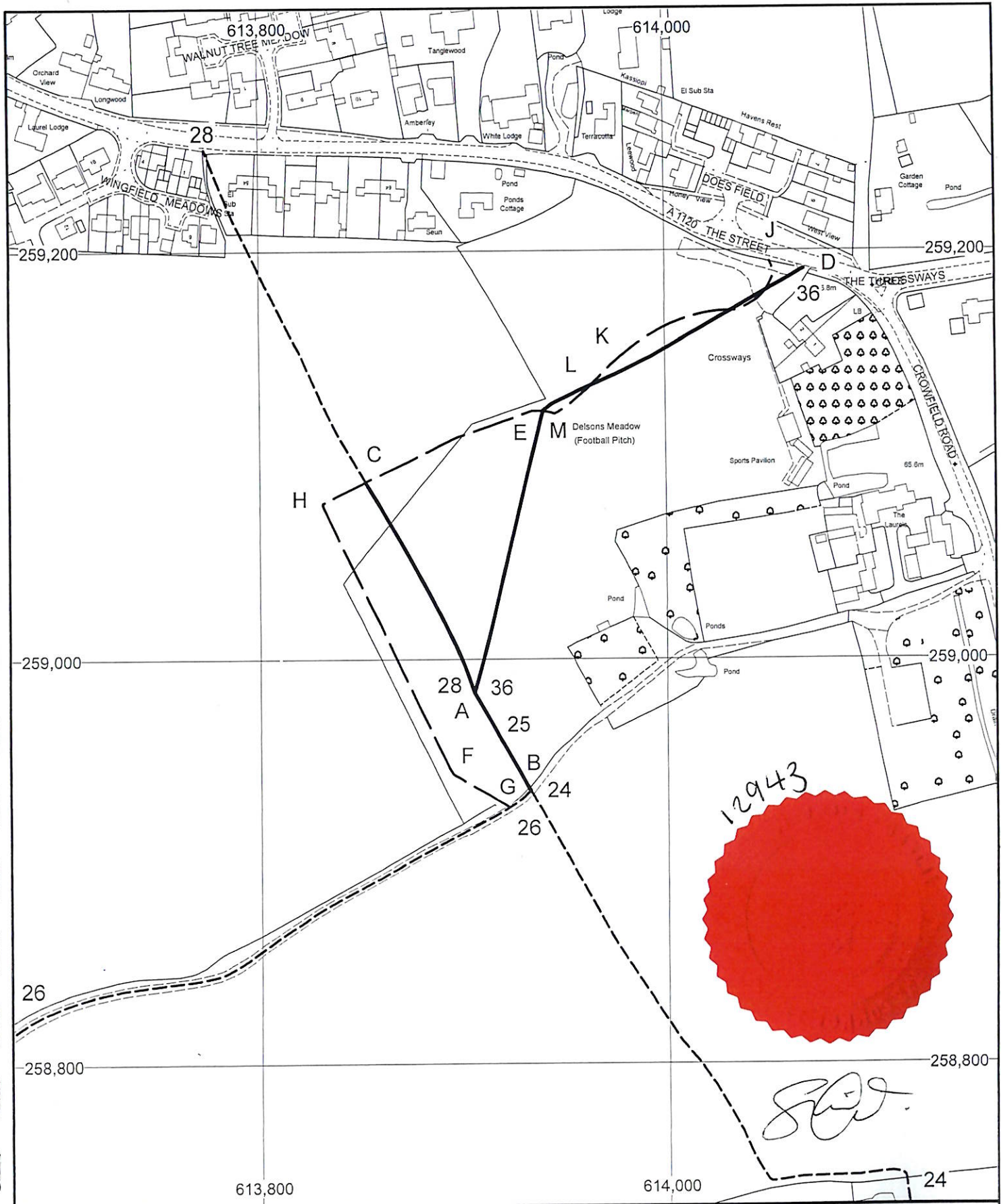

Width: 2 metres between points J – K – L – M

1.5 metres between points M – C



MAP REFERRED TO IN THE MID SUFFOLK DISTRICT COUNCIL (STONHAM ASPAL FOOTPATHS 25, 28(PART) AND 36) PUBLIC PATH STOPPING UP ORDER 2024 - TOWN AND COUNTRY PLANNING ACT 1990 SECTION 257

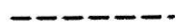

-  Footpath to be stopped up (A-B) (C-A) (D-E-A)
-  Proposed Footpath (F-G) (C-H-F) (J-K-L-M-C)
-  Unaffected footpath



Scale: 1:2,500 at A4